

### BUILDING REQUIREMENTS

| SPEED (M/MIN) | OVERHEAD (OH) | PIT DEPTH (PD) | M/C ROOM HEIGHT (MH) |
|---------------|---------------|----------------|----------------------|
| 30, 45        | 4400          | 1200           | 2400                 |

### STANDARD DIMENSIONS & REACTIONS

| TYPE                 | MODEL           | SPEED (M/MIN) | CLEAR OPENING OP | CAR              |                | HOISTWAY X x Y | M/C ROOM MX x MY | MACHINE ROOM |       |
|----------------------|-----------------|---------------|------------------|------------------|----------------|----------------|------------------|--------------|-------|
|                      |                 |               |                  | INTERNAL CA x CB | EXTERNAL A x B |                |                  | R1           | R2    |
|                      |                 |               |                  | STANDARD TYPE    | RRI-CLH2000-2U |                |                  | 30, 45       | 2350  |
|                      | RRI-CLH2500-2U  | 30, 45        | 2750             | 2750 x 6300      | 2850 x 6300    | 3600 x 6700    | 3600 x 6800      | 22500        | 12500 |
| DOUBLE ENTRANCE TYPE | RRI-CLH2000-2UD | 20, 30, 45    | 2350             | 2350 x 5300      | 2450 x 5300    | 3300 x 6000    | 3300 x 5800      | 17500        | 12000 |
|                      | RRI-CLH2500-2UD | 20, 30, 45    | 2750             | 2750 x 6300      | 2850 x 6300    | 3600 x 7000    | 3600 x 6800      | 22500        | 12500 |

\* Available in 2 ton & 2.5 tons capacity

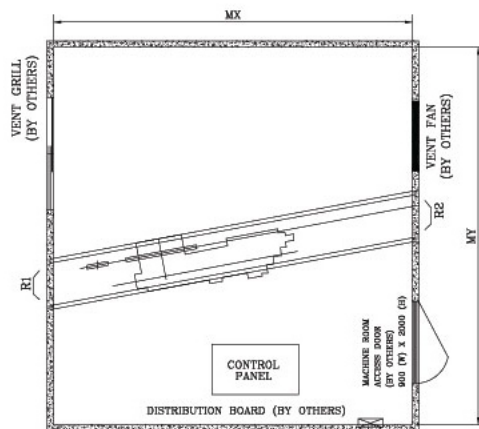
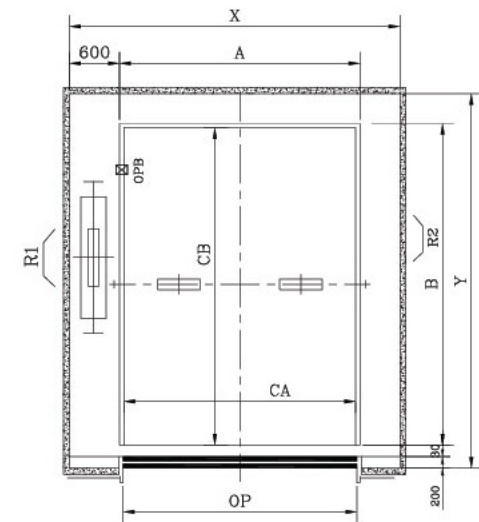

PLAN OF HOISTWAY & MACHINE ROOM

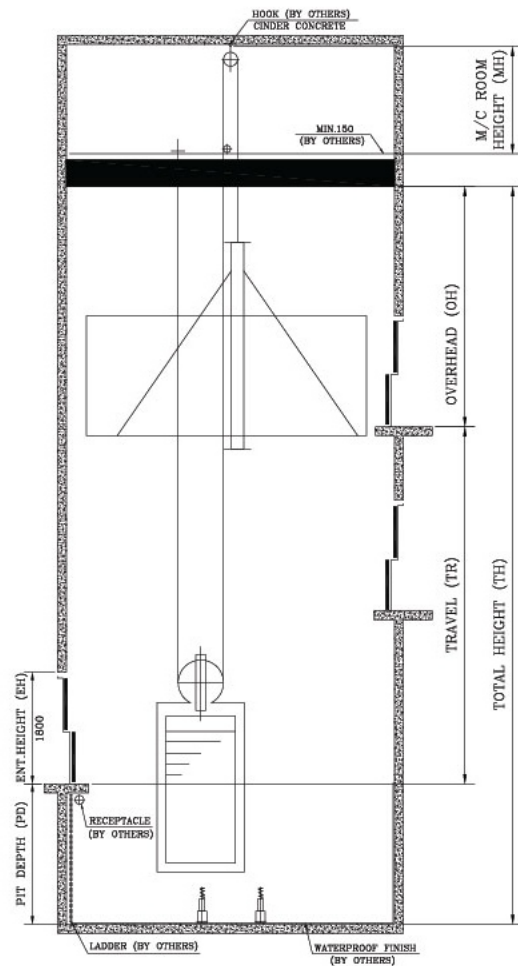

SECTION OF HOISTWAY

#### NOTES:

1. The car external sizes can be varied in line with entrance type.
2. The above are minimum sizes.
3. When non-standard capacities & dimensions are required, consult Ram Ratna Infrastructure Pvt. LTD.
3. All dimensions are in mm.